

STATIONARY | ROLLING | FLOATING | ACCESSORIES



INSTALLATION INSTRUCTIONS

FWM | DOCKS



ATTENTION

READ AND FOLLOW ALL SAFETY
RULES AND OPERATING
INSTRUCTION CAREFULLY BEFOR
ATTEMPTING TO INSTALL AND
OPERATE DOCK SYSTEM

Thank you for your purchase! We want to make your entire experience with FWM Docks as easy as possible. Please read each step of this Owner's Manual thoroughly to ensure proper installation of your new dock system. Installing your dock in any manner other than the steps outlined in the manual may lead to serious injury and or structural failure. If you have additional questions at any time please call, (603) 578-9699

Your safety and the safety of others is paramount. We have provided many important safety messages in this manual and on your dock system. Always read and obey all safety messages.



Danger / Caution

- Never allow anyone under or on the dock when installing or removing the dock.
- The use of a corded drill may cause electrocution.
- Never allow anyone to dive off the dock in shallow water
- Never run on the dock. The dock may be slippery when wet.
- Steps may be slippery. Hold onto handrails while walking down steps.
- If transporting a dock from one lake to another, be sure to follow any regulations regarding invasive species such as Zebra Mussels. Contact your local Department of Natural Resources or government agencies for further information. Help protect our lakes and rivers from any invasive species.
- If leg pads are sunk in mud, slowly rock or left to release mud before removing, or you may damage the dock.
- FWM Docks are designed "3 season safe". If you live in an area where the water freezes, we recommend taking your dock completely out of the water. To avoid water getting into the frame extrusion, never store the dock frame outside on its side. Be sure to store it in a safe area free from any falling debris.
- Speak with FWM or your authorized dealer to ensure the dock system, style, and anchoring solution are suitable for the style and layout of the dock you have selected.

IMPORTANT!

You should read these instructions thoroughly before assembling and installing your FWM Dock. Please adhere to all recommendations and cautionary suggestions appearing in this manual and always follow the instructions precisely. Please save these instructions and refer to them as needed for future reference.

Note: It is the dock owner/operator's responsibility to ascertain and comply with all applicable Federal, State, and local laws, ordinances, and regulations, as well as all inspection, permitting, and licensing requirements pertaining to the installation, application, and use of FWM products on the owner/operator's premises. FWM, Inc. assumes no duty or responsibility regarding the legality or compliance of the owner/operator's chosen installation, application, or use of FWM products.

SITE PREPARATION:

Each dock installation is site-specific. You should be aware of the specific body of water's unique characteristics and consider how such conditions will affect the dock system and the installation. Please take the following into account:

- Overall area of the body of water
- Water depth
- Normal and greatest wave action
- Water level fluctuation
- Fresh, brackish or salt-water
- Lakebed condition

Be certain that your installation configuration is designed to accommodate the daily intended use of your dock, in particular:

- Commercial application
- Public access requirements
- Scale of operation and use (size of boats, number of boats, number of people, etc.)
- Other special considerations affecting daily use.

ASSEMBLY OVERVIEW:

- Become familiar with the installation instructions before beginning
- Review the plans provided for your new dock system. Mentally layout where each part goes and organize your hardware accordingly. It is always best to have a plan of action before the start of your dock installation.
- Make sure the correct tools are available
- Verify that all dock sections and hardware are on site and ready for installation.
- Check your entire inventory to ensure that you have all the materials needed before starting the installation. Open each box or bag and compare the contents against the itemized list on your packing slip. If there are any missing or damaged items, please contact your dealer immediately

REQUIRED & RECOMMENDED TOOLS:

- Tape Measure
- Level
- Pipe Cutter / Sawzall
- 1/4" Allen Key
- 5/16" Allen Key
- 9/16" Wrench
- 3/4" Wrench
- 9/16" Socket
- Phillips Head Screw Driver
- Dead Blow Hammer

DOCK INSTALLATION OVERVIEW:

Step 1: If you wish to decrease each dock section's weight during the installation process, you can remove the panelized decking. This is done by removing the set screws along the perimeter of each decking panel.

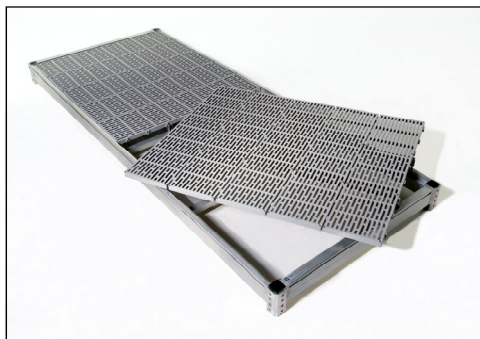

Step 2: With the first dock section still on land, install all four poles and leg pads into the dock frame. Set the dock leg pad at the higher of the two settings (8" up). Be sure to check the orientation of the stainless steel corner bracket inserts at this point. Some layouts will require repositioning of the corner bracket insert based on splice kit location. Using one of the two set screws, set the dock frame on the pole at an appropriate height based on the anticipated water depth. (Caution: Never walk on the dock when held with one set screw.)

Step 3: Loosely install splice kit connection hardware onto the dock section. (See separate splice kit installation instructions.) Install an installation clip at the end of the dock section or at the position you plan to connect your next dock section.

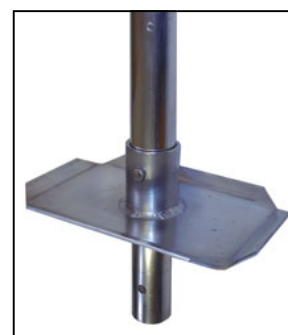

Step 4: Walk the first section into place in the water. (If you are using a transition ramp, be sure to take that length into account.) Make sure your dock system is moderately level. Relieve the set screw at each pole in the corner bracket one at a time and drive the pole into the ground by either stepping on the leg pad or by using a dead blow hammer. If you cannot drive the leg into the ground due to a rocky environment, you may lower the leg pad down to the bottom setting. This allows the leg pad to sit flush on the bottom of the leg. (Always install as many legs as possible at the higher leg pad setting.)

Step 5: With the first dock section in the water, level the dock on both the length and width sides and secure the dock on the pole by tightening both set screws with a 1/4" Allen key (position 1 & 4). If you are installing a transition ramp from the shore to your first dock section, move your set screw from position 1 to position 2. This allows your ramp to move up and down easily and positions it flush with your dock's top.

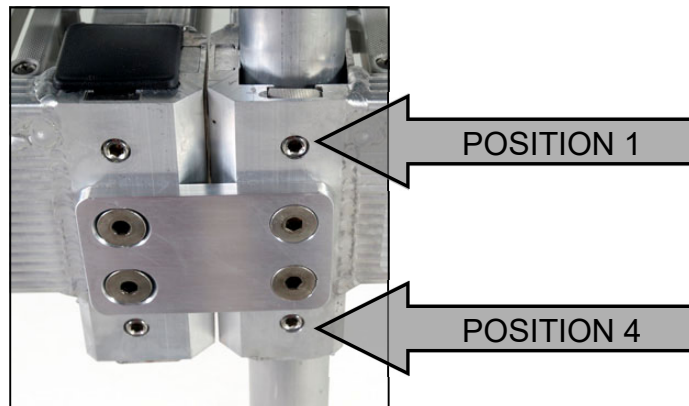

Step 6: Each subsequent dock section should be prepped onshore, as described above. This means installing all dock legs and pads (set each leg height as close to the anticipated water depth as possible), Installation clips, Cross Braces (needed if your dock will be more than 5' above ground), and any splice kit hardware (loosely attached) needed for additional sections.

Each dock section will have legs filling every corner bracket except for those in direct contact with previously installed sections (i.e. On a 4'x20' dock with two 4'x10' sections, the first section has four poles, 2ea. at 0', 2ea @ 10'. The next dock section has only 2ea. at 20'.)

Step 7: Once the next dock section is prepped, walk it into the water. Rest one end on the installation clip and repeat the steps above.

Step 8: Continue this process for each dock section until you have reached your desired layout. If water depths make it difficult to walk the dock section into place, you may float the dock section into place using flotation tanks or some other supplemental flotation device to ease installation.



Step 9: If you previously removed decking panels from the dock frame, reinstall them at this point. Slide one piece on the dock frame about one foot in from the end. Use the matching panel to link them together and slide them both into position. Use a Phillips head screwdriver to reinstall your decking set screws into the predrilled holes.

Step 10: Trim all poles to your desired height with the tool of your choice (sawzall / pipe cutter / hacksaw). We recommend trimming them to the same height, between 16"-36".

Step 11: Place caps on all poles and fill all non-used corner brackets with provided plugs.

Step 12: Install any accessories that have been purchased,

BE SURE TO DO A FINAL WALKAROUND OF THE DOCK TO ENSURE ALL SCREWS ARE TIGHTENED BEFORE STANDING ON OR WALKING ON THE DOCK.



TRANSITION RAMP (6032, 6033, 6034, 6035, 6040, 6041, 6042, 6043, 6044, 6045)

(<https://fwmdocks.com/product/transition-ramps/>)

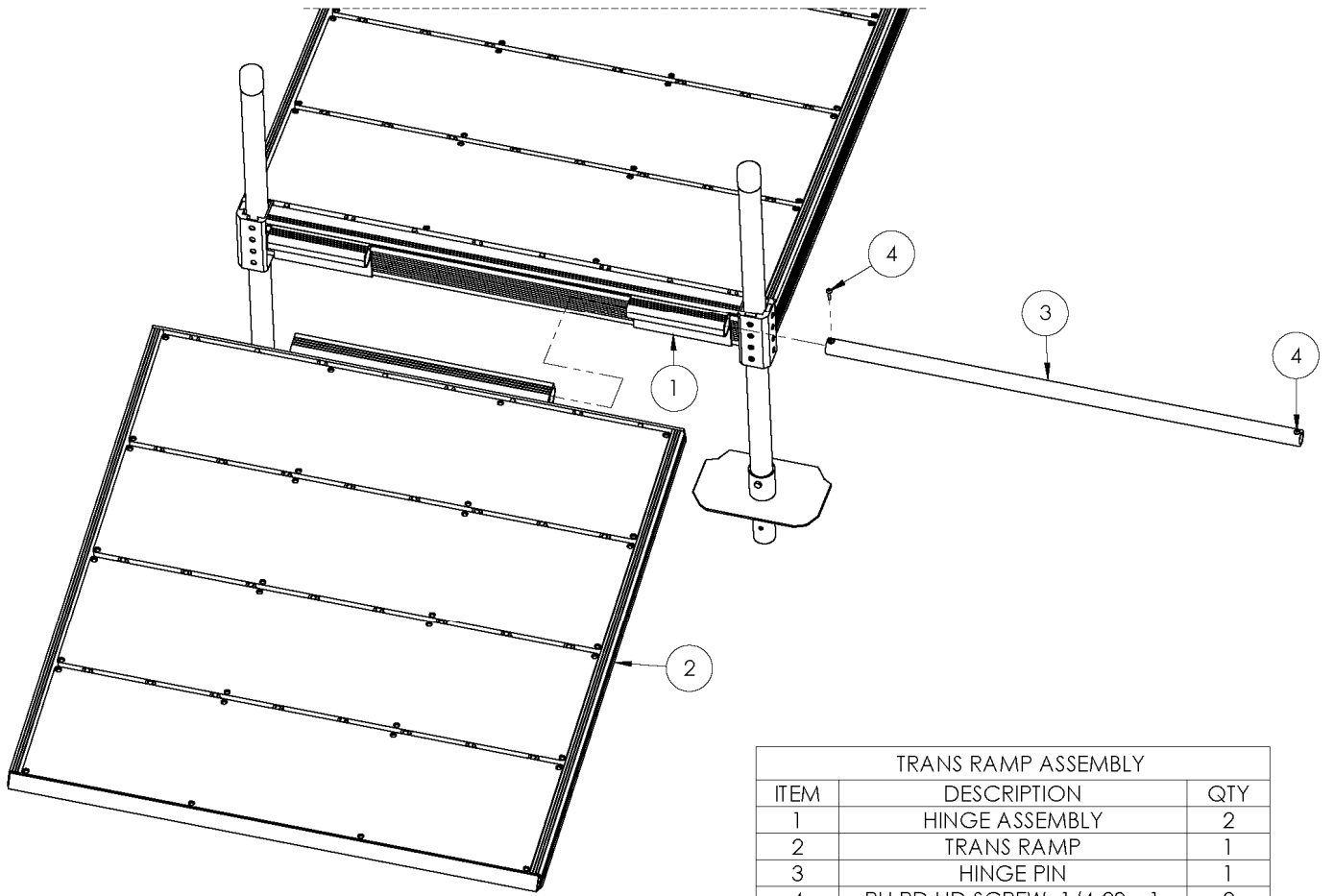

TRANS RAMP ASSEMBLY		
ITEM	DESCRIPTION	QTY
1	HINGE ASSEMBLY	2
2	TRANS RAMP	1
3	HINGE PIN	1
4	PH RD HD SCREW 1/4-20 x 1	2

STANDARD SPLICE KIT (5001)

<https://fwmdocks.com/product/standard-splice-kit-for-aluminum-dock/>

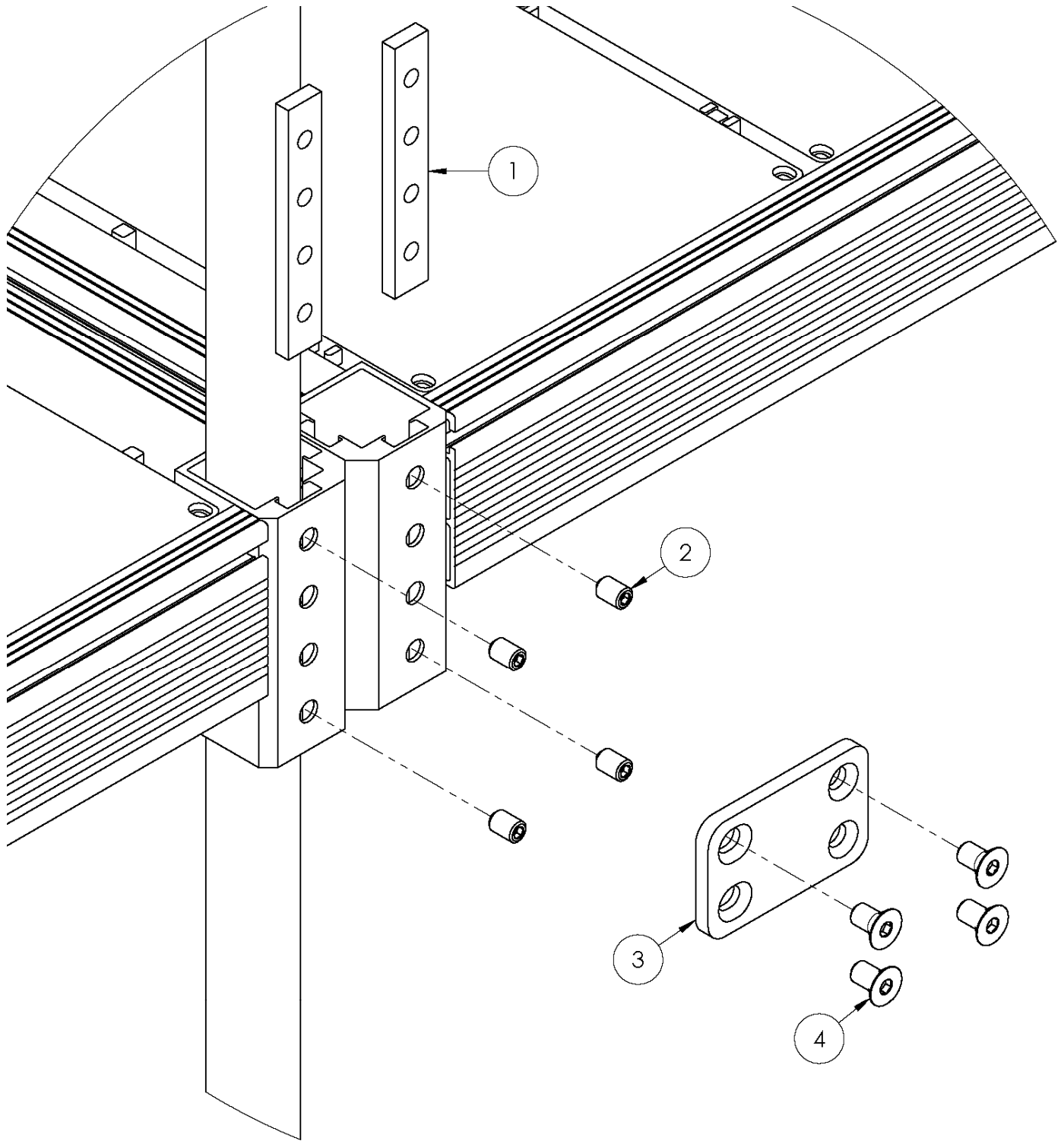

SPLICE KIT		
ITEM	DESCRIPTION	QTY
1	CORNER POST INSERT	2
2	SET SCREW 1/2-13 x 3/4	4
3	SPLICE BRACKET	1
4	FLAT HEAD ALAN SCREWS 1/2-13 x 7/8	4

PARALLEL SPLICE KIT (5006)

<https://fwmdocks.com/product/parallel-splice-kit-for-aluminum-dock/>

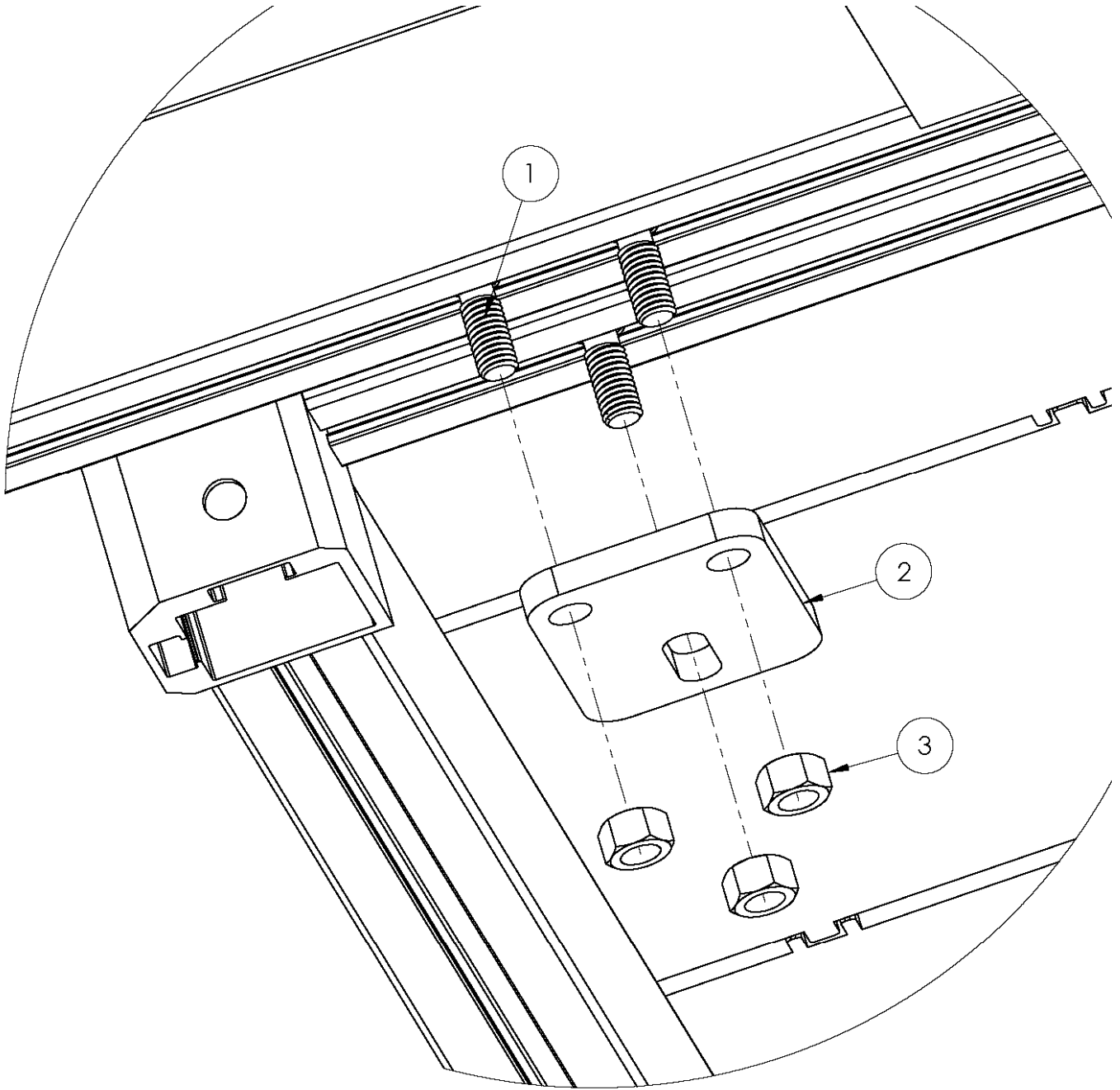

PARALLEL SPLICE KIT		
ITEM	DESCRIPTION	QTY
1	TRACK BOLT	3
2	SPLICE BRACKET	1
3	HEX NUT 1/2-13	3

HORIZONTAL BUMPER (6031)

<https://fwmdocks.com/product/horizontal-bumper/>

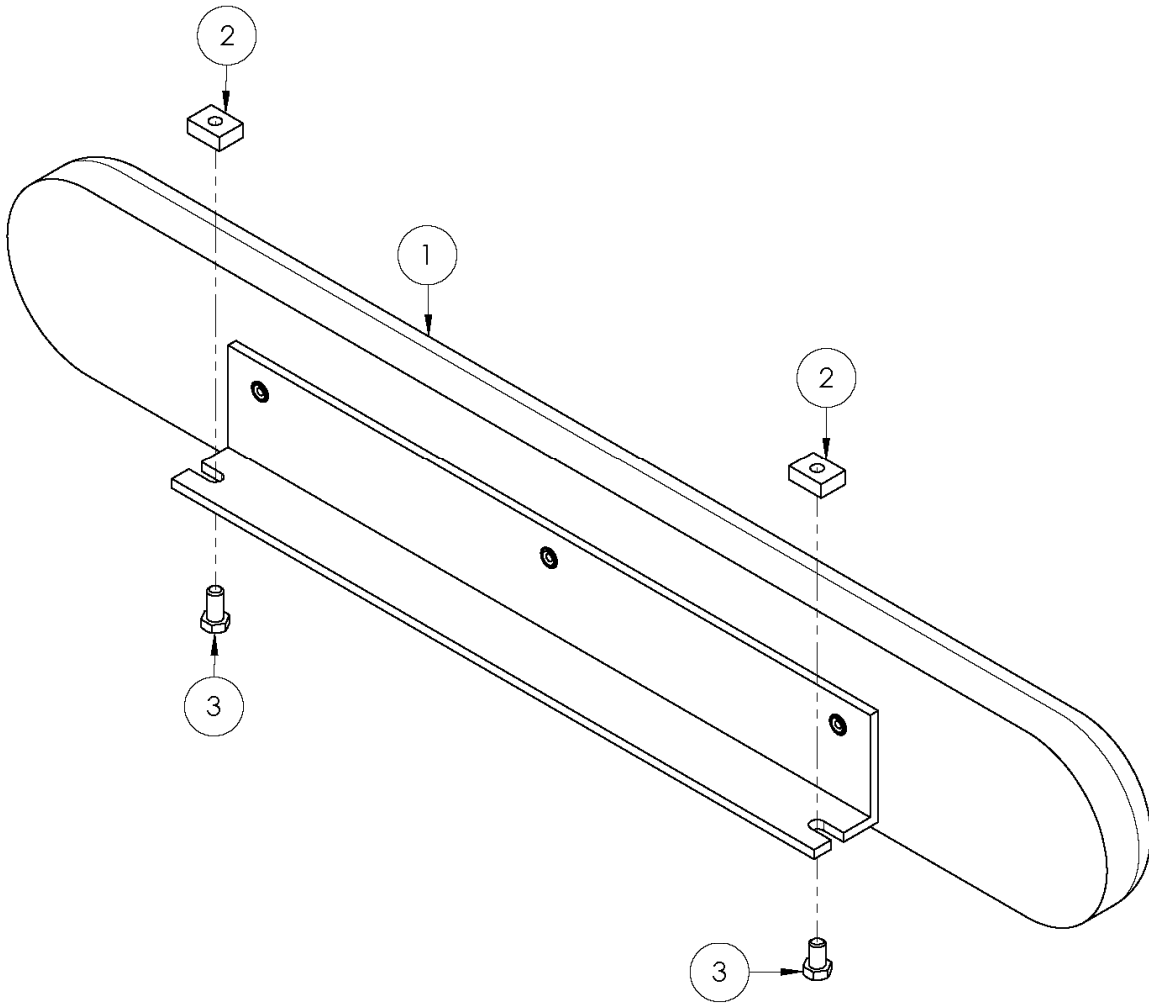

HORIZONTAL BUMPER		
ITEM	DESCRIPTION	QTY
1	BUMPER	1
2	TRACK NUT	2
3	HEX BOLT 3/8 x 3/4	2

WHEEL KIT CROSS BRACE

TWO BOLTS AND TRACK NUTS PER BRACE.
SIDE TRACK NUTS INTO APPROXIMATE POSITION BEFORE INSTALLING BRACES.
APPLY SLIGHT PRESSURE TO ALIGN BRACES WITH TRACK NUTS.

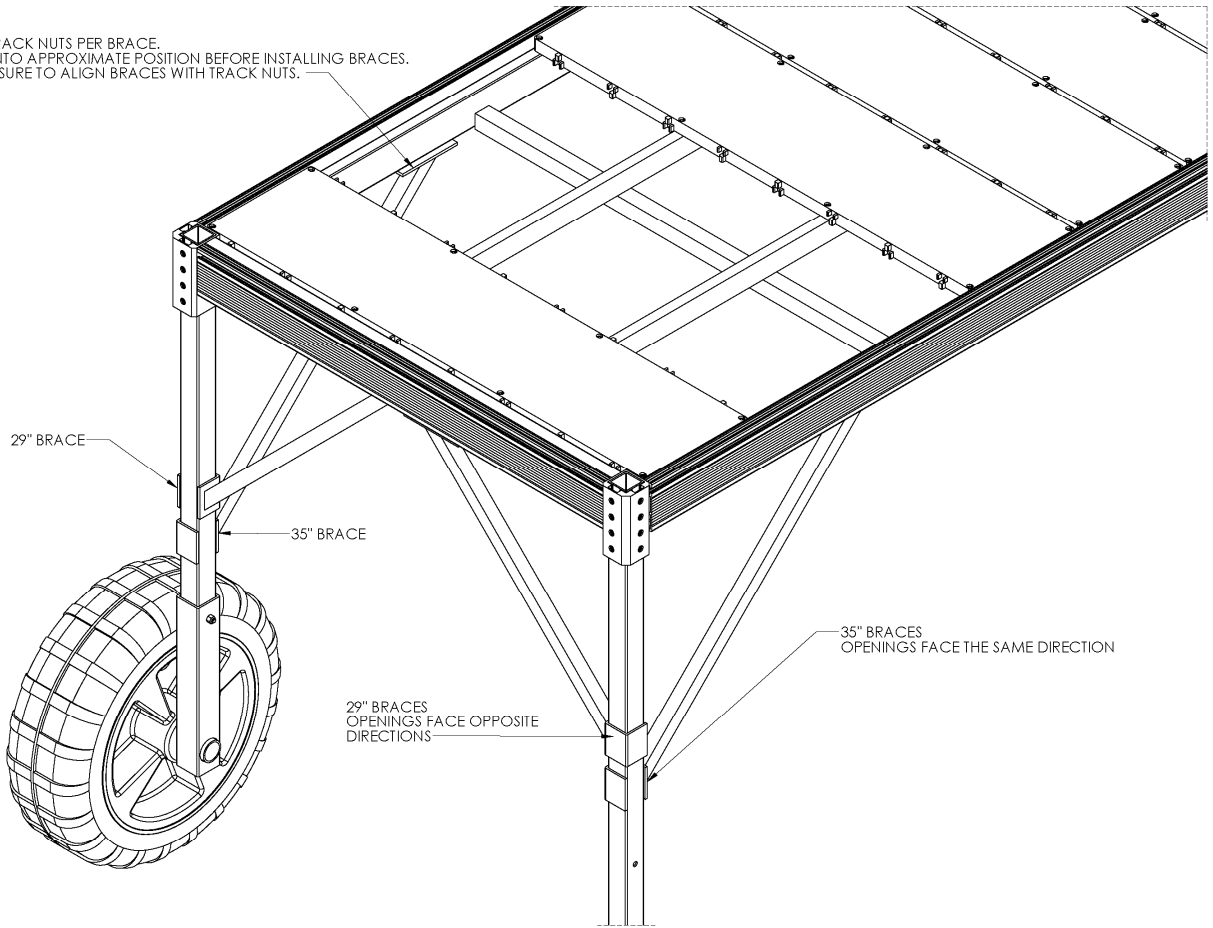

Aluminum Leg and Leg Pad

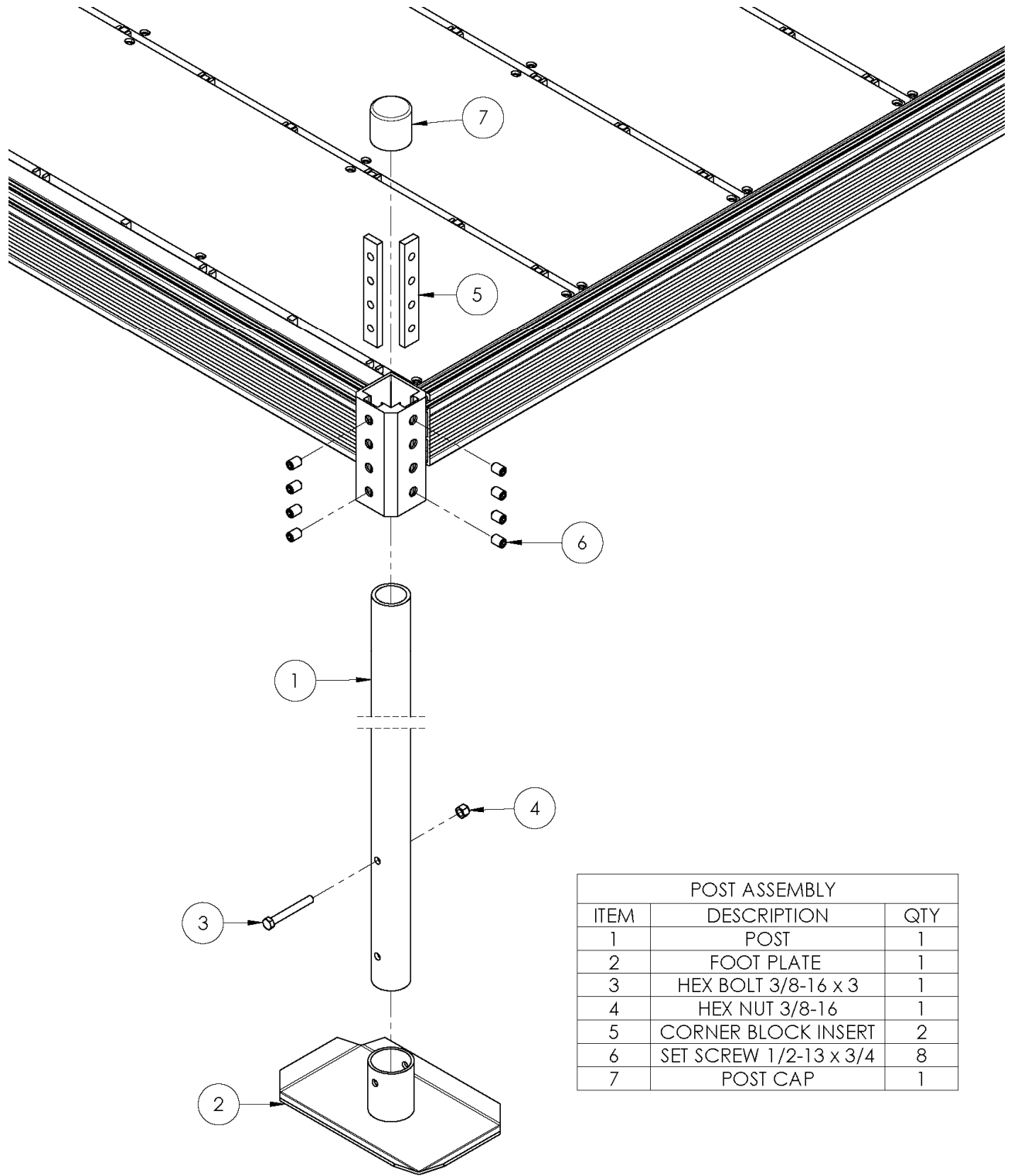

POST ASSEMBLY		
ITEM	DESCRIPTION	QTY
1	POST	1
2	FOOT PLATE	1
3	HEX BOLT 3/8-16 x 3	1
4	HEX NUT 3/8-16	1
5	CORNER BLOCK INSERT	2
6	SET SCREW 1/2-13 x 3/4	8
7	POST CAP	1

CORNER GUSSET (6026, 6027, 6062, 6063, 6064, 6065)

<https://fwmdocks.com/product/corner-gusset-thruflow/>

CORNER GUSSET INSTALLATION		
ITEM	DESCRIPTION	QTY
1	CORNER GUSSET	1
2	PARALLEL SPLICE KIT	3

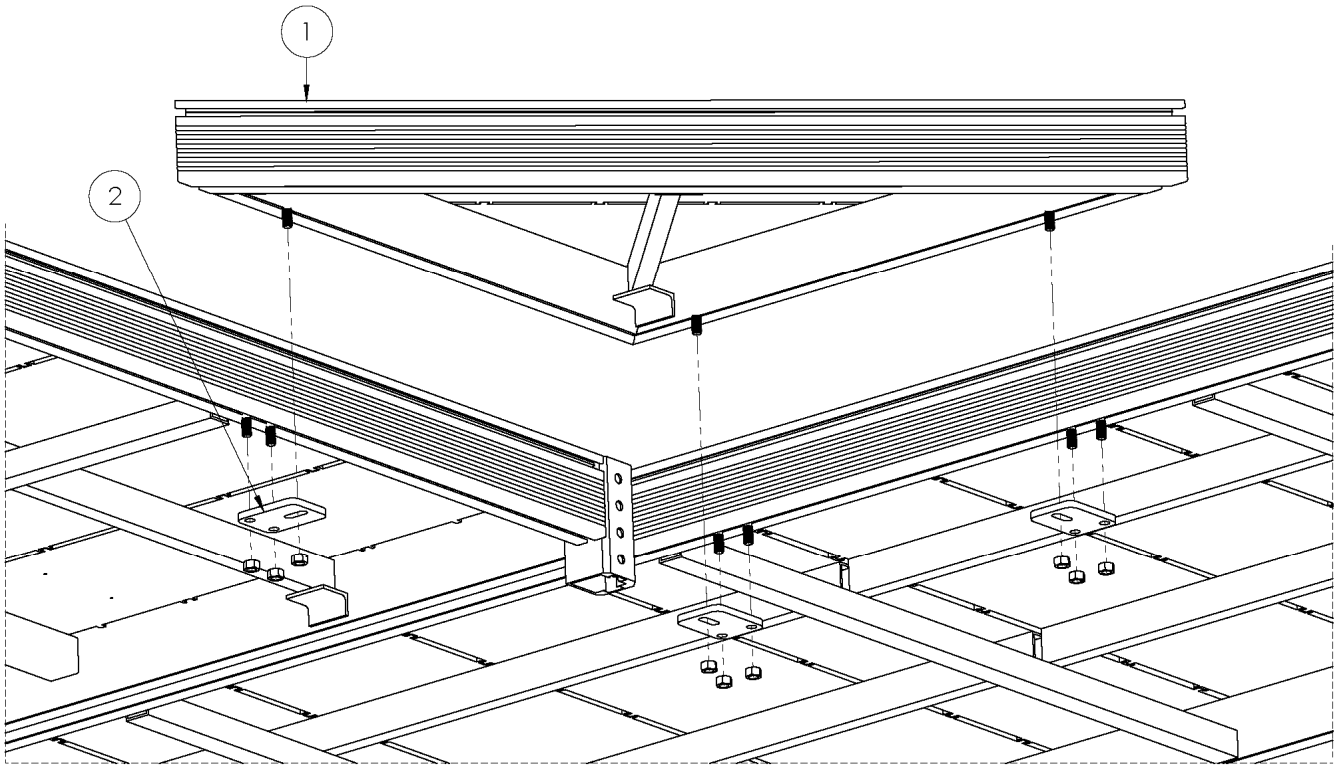

BOARDING STEP (6070, 6071)

<https://fwmdocks.com/product/6-boarding-step-water-bench/>

BOARDING STEP		
ITEM	DESCRIPTION	QTY
1	PLATFORM	1
2	SUPPORT	2
3	SET SCREW BAR	2
4	SET SCREW 1/2-13 x 3/4	4
5	BTN HD ALAN BOLT 3/8-16 x 7/8	8
6	HEX HD BOLT 3/8-16 x 3/4	4

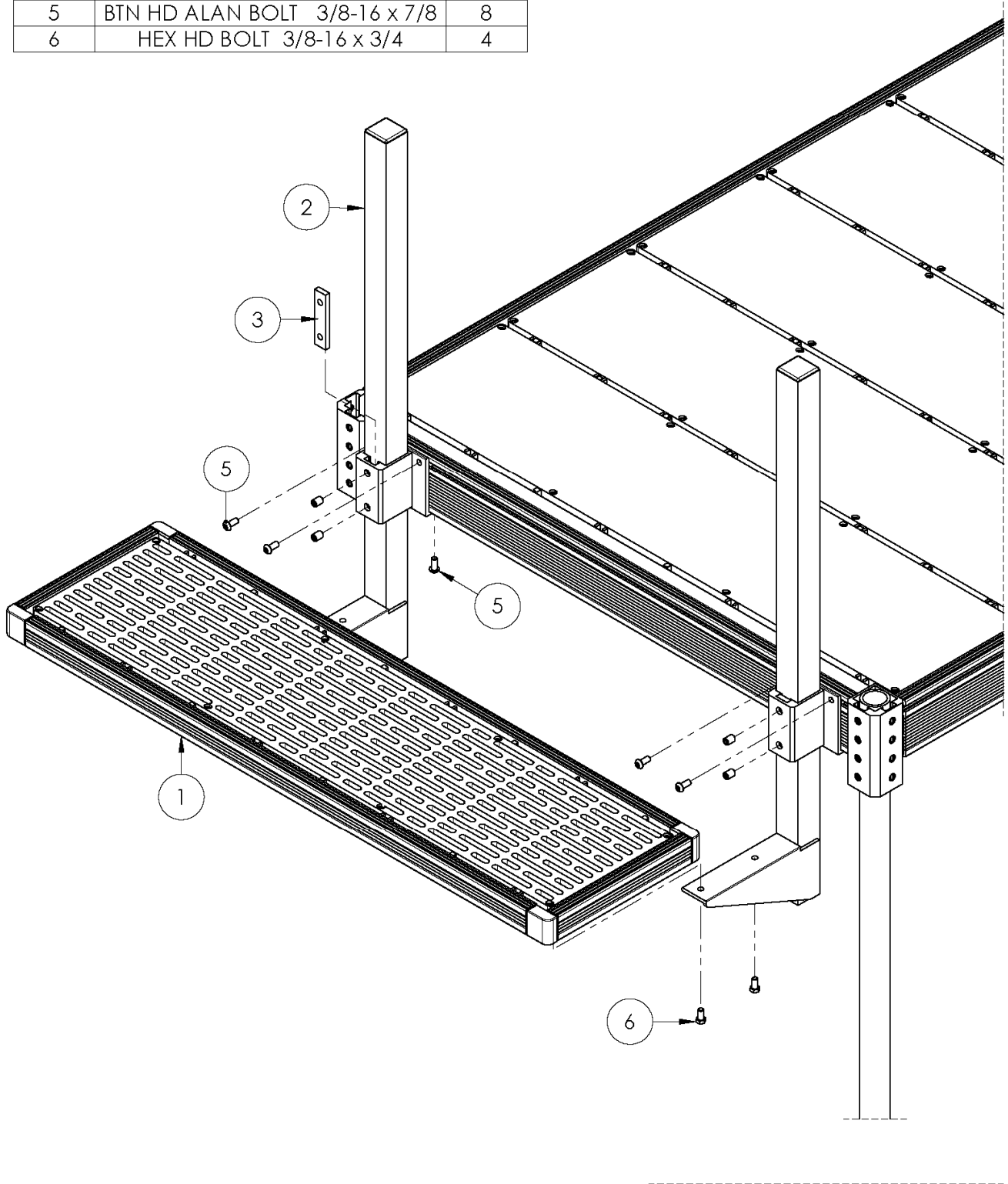

Adjustable Vertical Bumper

(<https://fwmdocks.com/product/adjustable-vertical-bumper/>)

ADJUSTABLE BUMPER ASSEMBLY

ITEM	DESCRIPTION	QTY
1	Adjustable Bumper Mount	1
2	Adjustable Bumper	1
3	Hex Bolt 1/2-13 x 1-1/4, Released	2
4	Knob	1
5	Track Nut, 3/8-16	2
6	Hex Nut, 1/2-13	1
7	Flat Head Alan Bolt 3/8-16 x 1	2

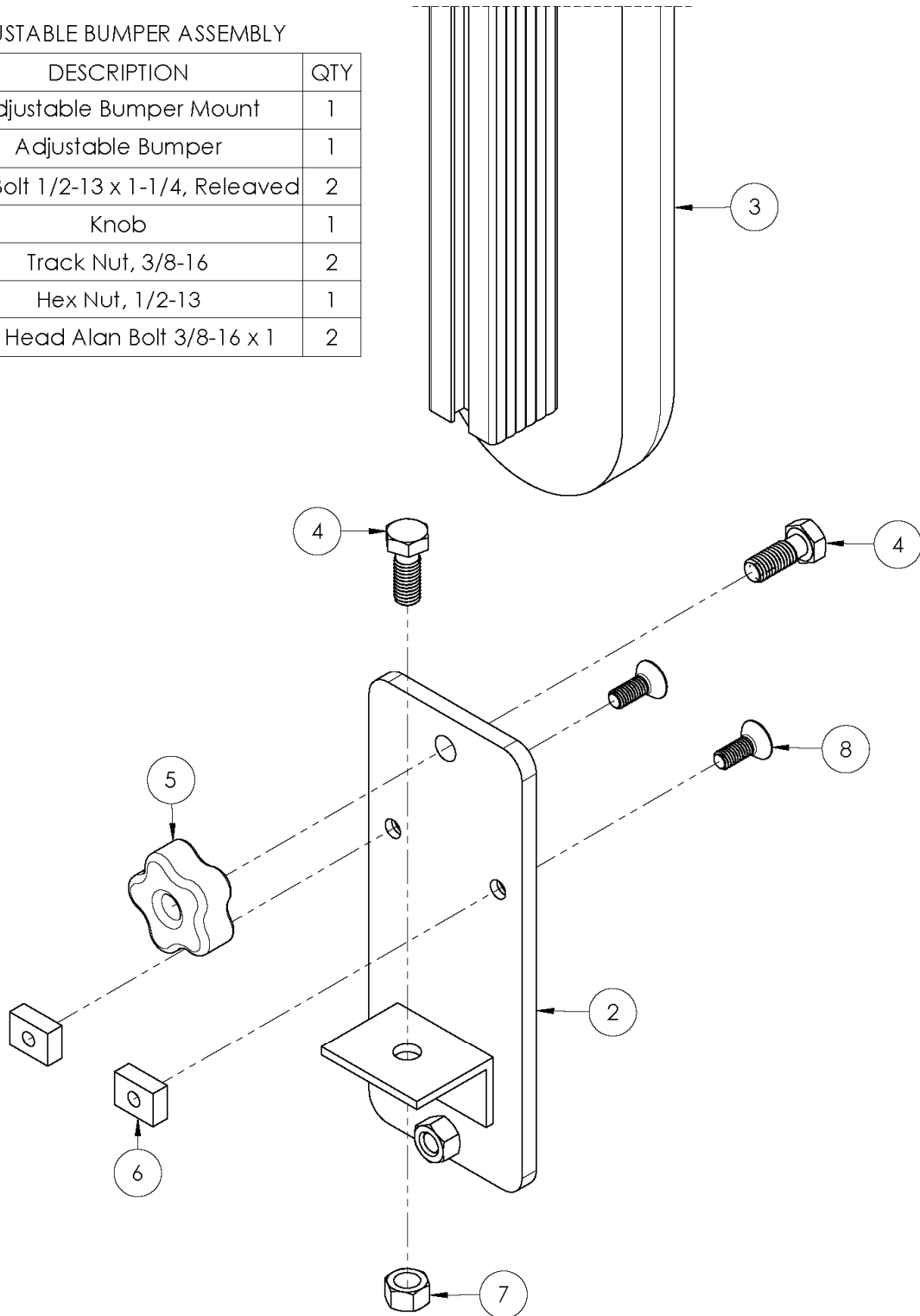

FWM Bench Kit

(<https://fwmdocks.com/product/fwm-bench-kit/>)

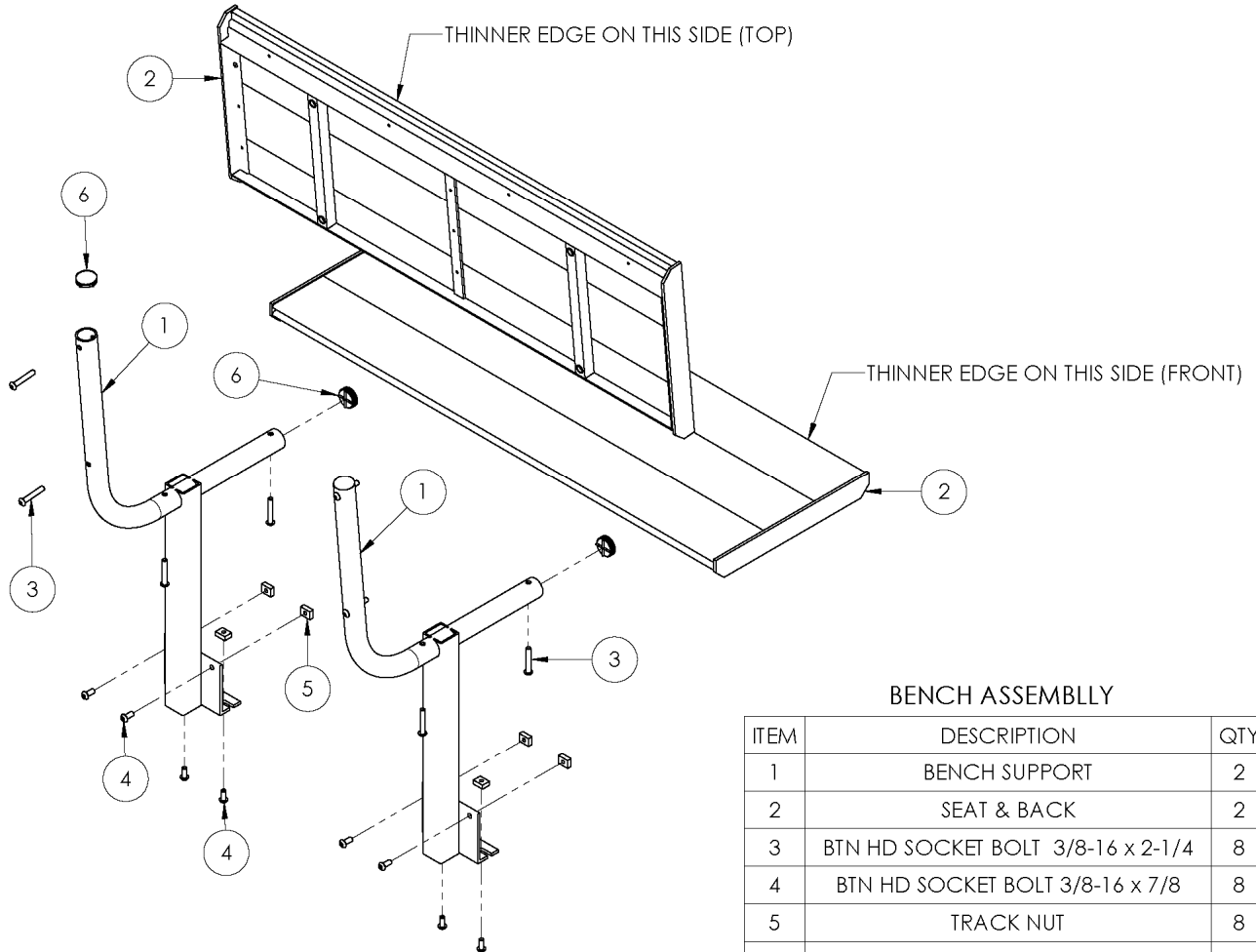

Gangway Transition Plate

(<https://fwmdocks.com/product/gangway-transition-plate/>)

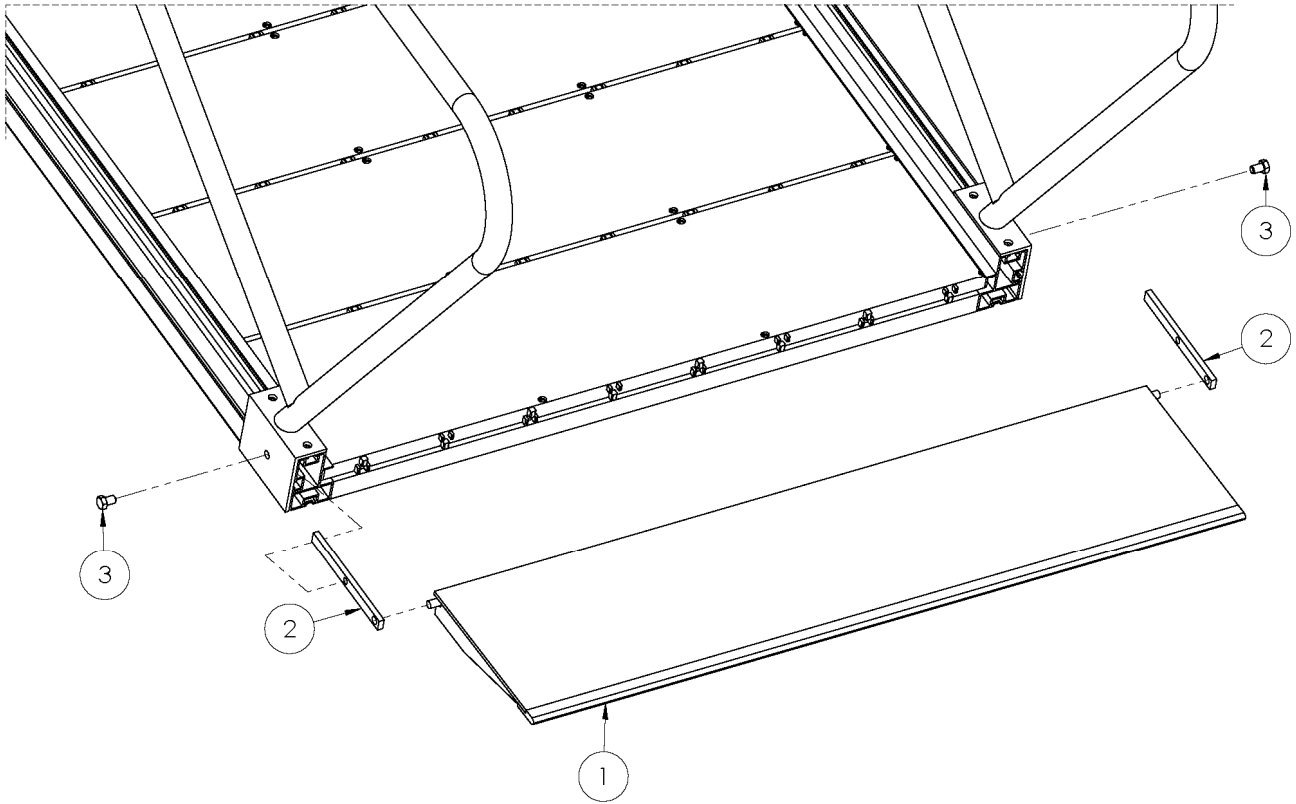

GANGWAY TRANSITION RAMP

ITEM	DESCRIPTION	QTY
1	TRANSITION RAMP	1
2	SUPPORT BAR	2
3	HEX BOLT 1/2-13 x 3/4	2

Gangway Railing Attachment

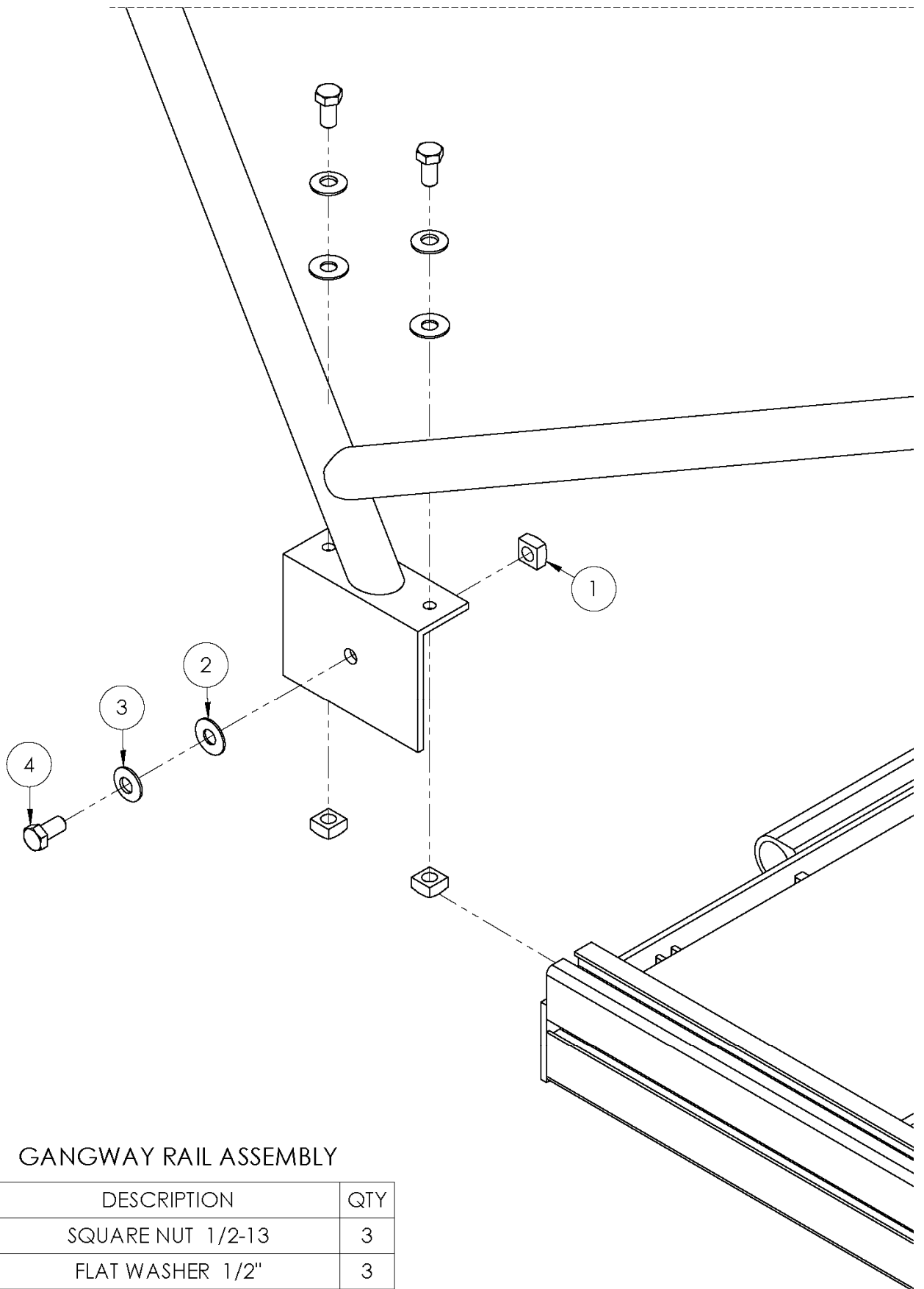

GANGWAY RAIL ASSEMBLY

ITEM	DESCRIPTION	QTY
1	SQUARE NUT 1/2-13	3
2	FLAT WASHER 1/2"	3
3	LOCK WASHER 1/2" BELLEVILLE	3
4	HEX BOLT 1/2-13 x 1	3

Kayak Rack

(<https://fwmdocks.com/product/kayak-rack-for-fwm-dock/>)

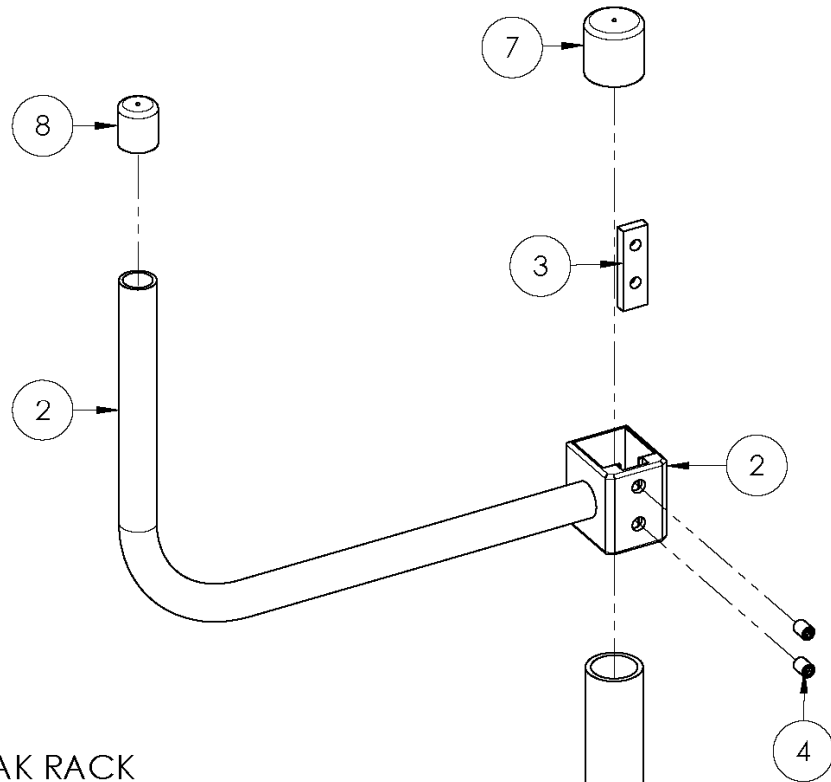

KAYAK RACK

ITEM	DESCRIPTION	QTY
1	POST, RAIL MOUNT	1
2	SUPPORT ARM	1
3	SET SCREW BAR	1
4	SET SCREW 1/2-13 x 3/4	2
5	TRACK NUT 3/8-13	4
6	HEX BOLT 3/8-16 x 3/4	4
7	PLASTIC CAP 2"	1
8	PLASTIC CAP 1-5/16"	1

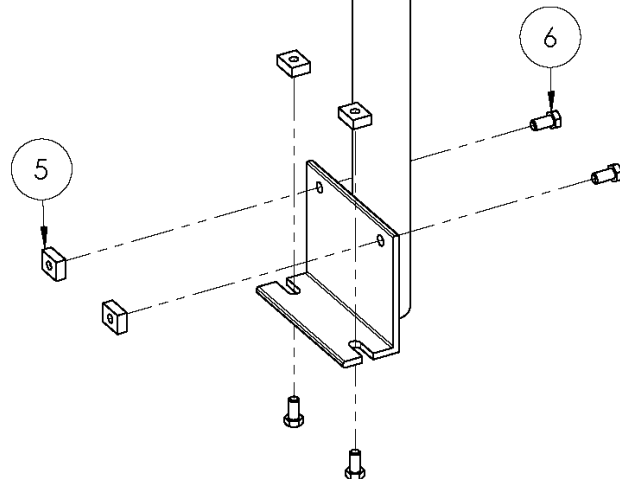

Four Step Self Leveling Stairs

(<https://fwmdocks.com/product/stairs/>)

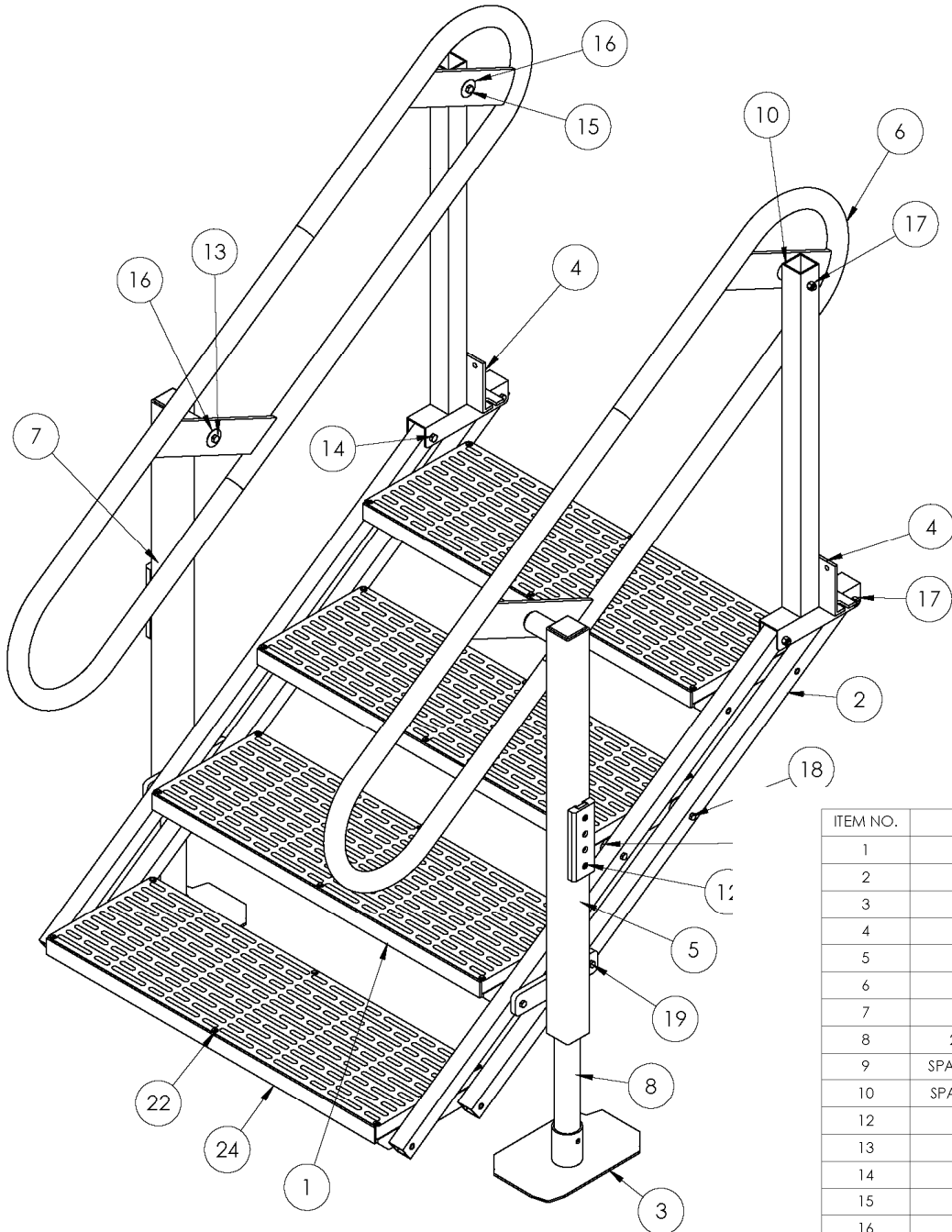

ITEM NO.	Description	QTY.
1	STAIR TREAD ASSEMBLY	3
2	STAIR STRINGER	4
3	LEG PAD	2
4	STAIR COUPLER	2
5	POST SUPPORT, SQ	2
6	HAND RAIL	2
7	SET SCREW BAR	2
8	2.0 OD x .188 WALL X 44" LONG TUBE	2
9	SPACER, 1.5OD x .515 ID x .250 THICK, 6061	16
10	SPACER 1.5 OD x .391 ID x .75 THICK, 6061	2
12	Set Screw 1/2-13 x .75 CUP POINT SS	4
13	3/8-16 x 1-1/4 HEX HD BOLT	2
14	3/8-16 x 2-1/2 HEX HEAD BOLT	4
15	3/8-16 x 3-3/4 HEX HD BOLT	2
16	3/8 x 1-12 FENDER WASHER	4
17	3/8-16 HEX NUT w/ NYLON INSERT	12
18	5/16-18 x 2-1/2 HEX HD BOLT	12
19	5/16-18 x 4 HEX HD BOLT	4
20	5/16 FLAT WASHER, .75 OD x .344 ID	16
21	5/6-18 HEX NUT w/ NYON INSERT	16
22	10-32 x 1-3/8 PH PAN HD MS	16
23	10-32 ACORN NUT	16
24	THRU-FLOW w/ TABS REMOVED	4
*	TRACK NUTS 3/8-16	8
*	3/8-16 x 1 HEX HD BOLT	4
*	3/8-16 x 3/4 HEX HD BOLT	4

* DOCK MOUNTING HARDWARE

Cross Brace

(<https://fwmdocks.com/product/6-dock-section-cross-bracing/>)

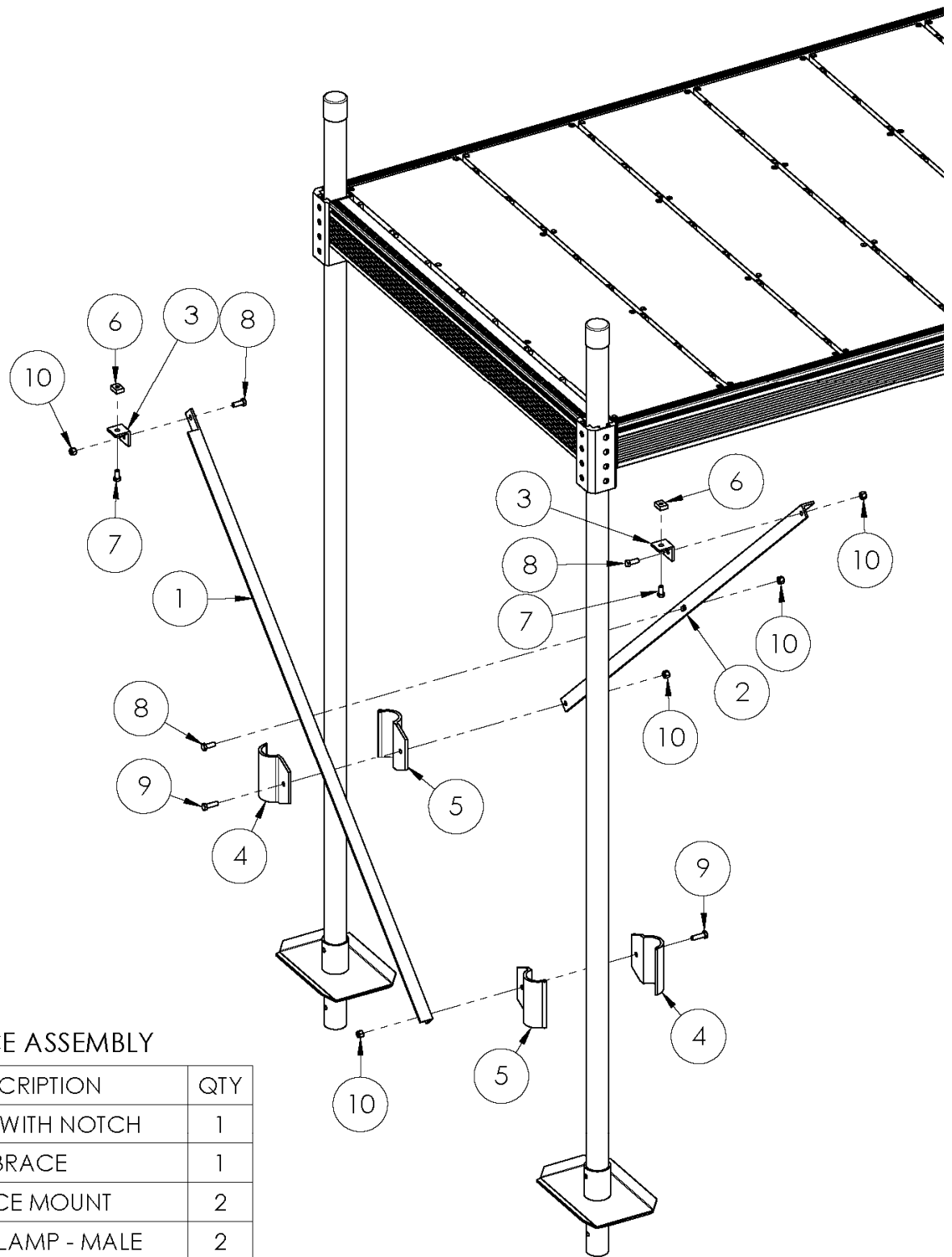

X-BRACE ASSEMBLY

ITEM	DESCRIPTION	QTY
1	BRACE WITH NOTCH	1
2	BRACE	1
3	BRACE MOUNT	2
4	POST CLAMP - MALE	2
5	POST CLAMP - FEMALE	2
6	TRACKNUT	2
7	HEX BOLT 3/8-16 x 3/4	2
8	HEX BOLT 3/8-16 x 1	3
9	HEX BOLT 3/8-16 x 1-1/4	2
10	HEX NUT 3/8-16	5